

The Best of Suncadia—a ridge view

1110 Pinegrass Loop, Lot 242
Cle Elum, WA 99922

MLS# 28197046

Offered at \$595,000

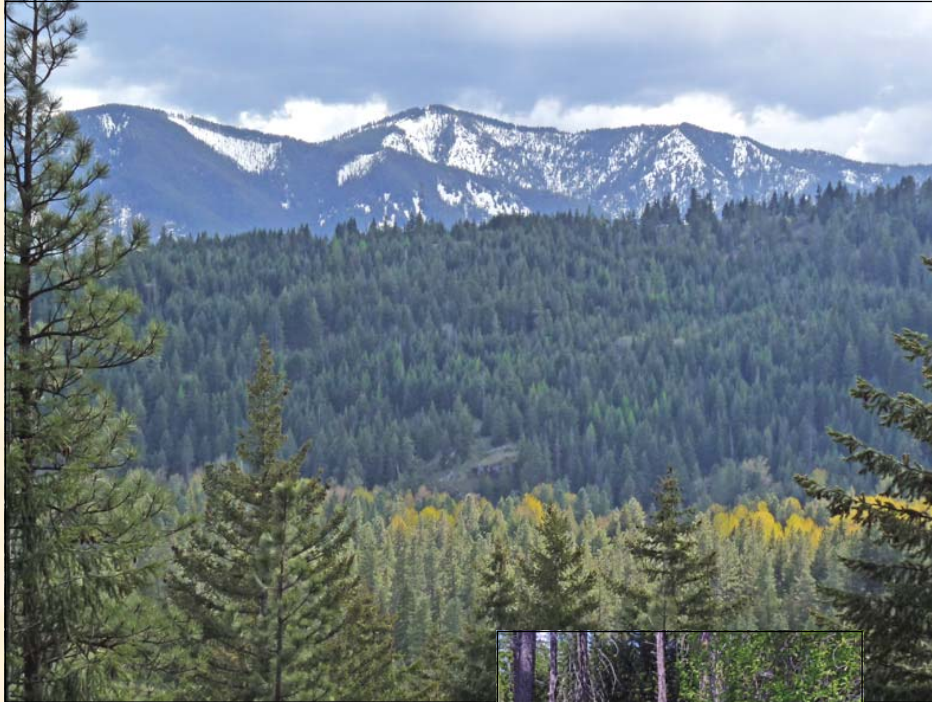

View from south rim of Lot 242 in early spring

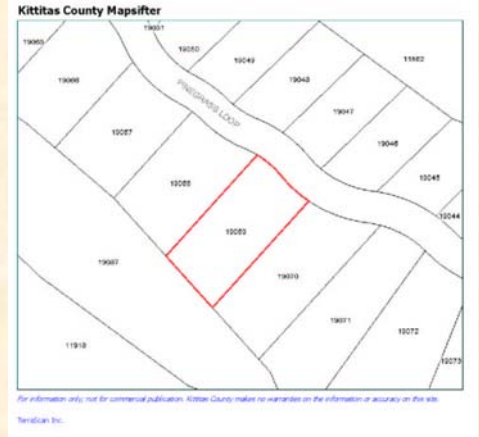

An easy-to-build rectangular site with good street access

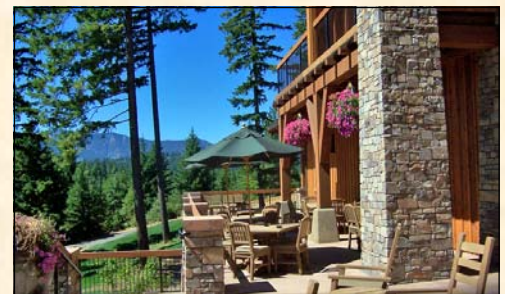

Relax on the sunny Prospector Inn veranda after a round of golf

A

short hike, bike or ride will take you to Suncadia village center for dining, teeing off on the Prospector course, working out at the fitness center or relaxing at Glade Springs Spa.

Beautiful mountain views and adjacent protected open space make this ridge property a premier home site.

Approximately 0.72 acre, level and nicely treed.

DIRECTIONS:

From Seattle approx. 80 miles east on Interstate-90 to Bullfrog Road, exit 80. Left across the freeway and Cle Elum River approx. 2 miles to Suncadia entrance roundabout. Enter resort on Suncadia Trail, then approx. 1.2 miles to roundabout. Take Pinegrass Loop approx. 0.8 miles. Lot 242 is on the ridge to the left (south).



PRESENTED BY
R. LEE HICKS

BROKER
Licensed in Oregon and
Washington



206-953-3041 (VM)
www.rleehicks.com
leemvnews@aol.com

Washington & Oregon Properties

Residential-Commercial-Investment Real Estate

Box 3500 PMB 115 (mail)
801 Highway 20
Building 3, Suite 16
Sisters, Oregon 97759

2035 43rd Avenue East
Suite 204
Seattle, Washington 98112



The information herein is deemed reliable but not guaranteed. Interested parties are advised to seek advice from government agencies and independent counsel regarding land use, zoning, water rights, utilities and other issues related to the acquisition of real estate.